

△ Recommended P.C.B. Layout (Top Side)
 (PCB Board Tolerance ± 0.05)

△ SPECIFICATION
 Current Rating: 3.0 Amp
 Contact Resistance: 20 Milliohms Max.
 Insulation Resistance: 1000 Megaohms Min.
 Withstand Voltage: 1000V AC/DC
 Operation Temperature: -40°C To $+105^{\circ}\text{C}$
 Contact: Brass, Gold Plated Over Nickel
 Insulator: PBT+30%G.F.(UL94V-0), Black
 RoHS Compliant

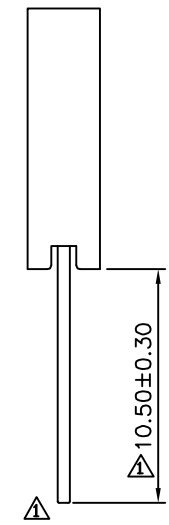
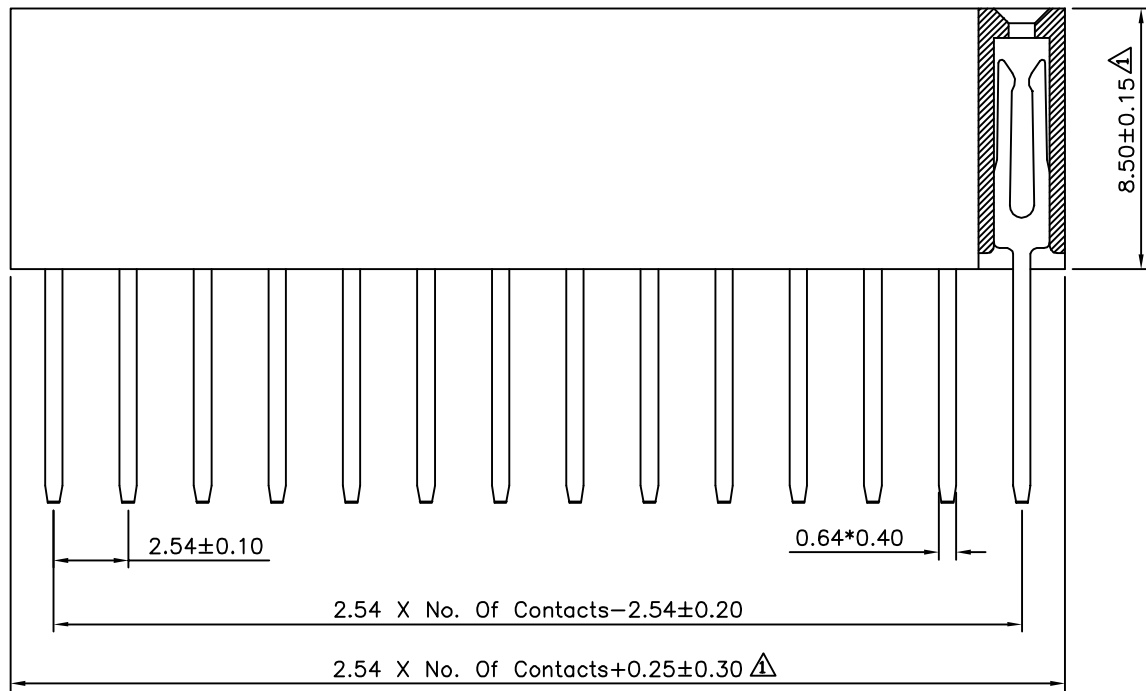
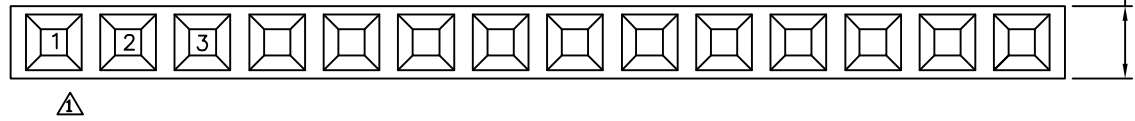

4UCON 元化興業股份有限公司
 4UCON TECHNOLOGY INC.

DRAWING No.		APPROVED BY		UNLESS OTHERWISE SPECIFIED TOLERANCES ARE .X ± 0.40 .XX ± 0.25 .XXX ± 0.15 ANG. $\pm 3^{\circ}$
18688		MEI		
		CHECKED BY HZF		
		DRAWING BY PEGA		
SCALE	NONE	REV.	A1	UNIT mm

NO.	REV.	REVISIONS	CHK	DATE
△ A1		Modify Data	HZF	04/02/2010
△ A0		NEW RELEASE	HZF	02/08/2007